

SD-AZ03 SHOWER PANEL SERIES

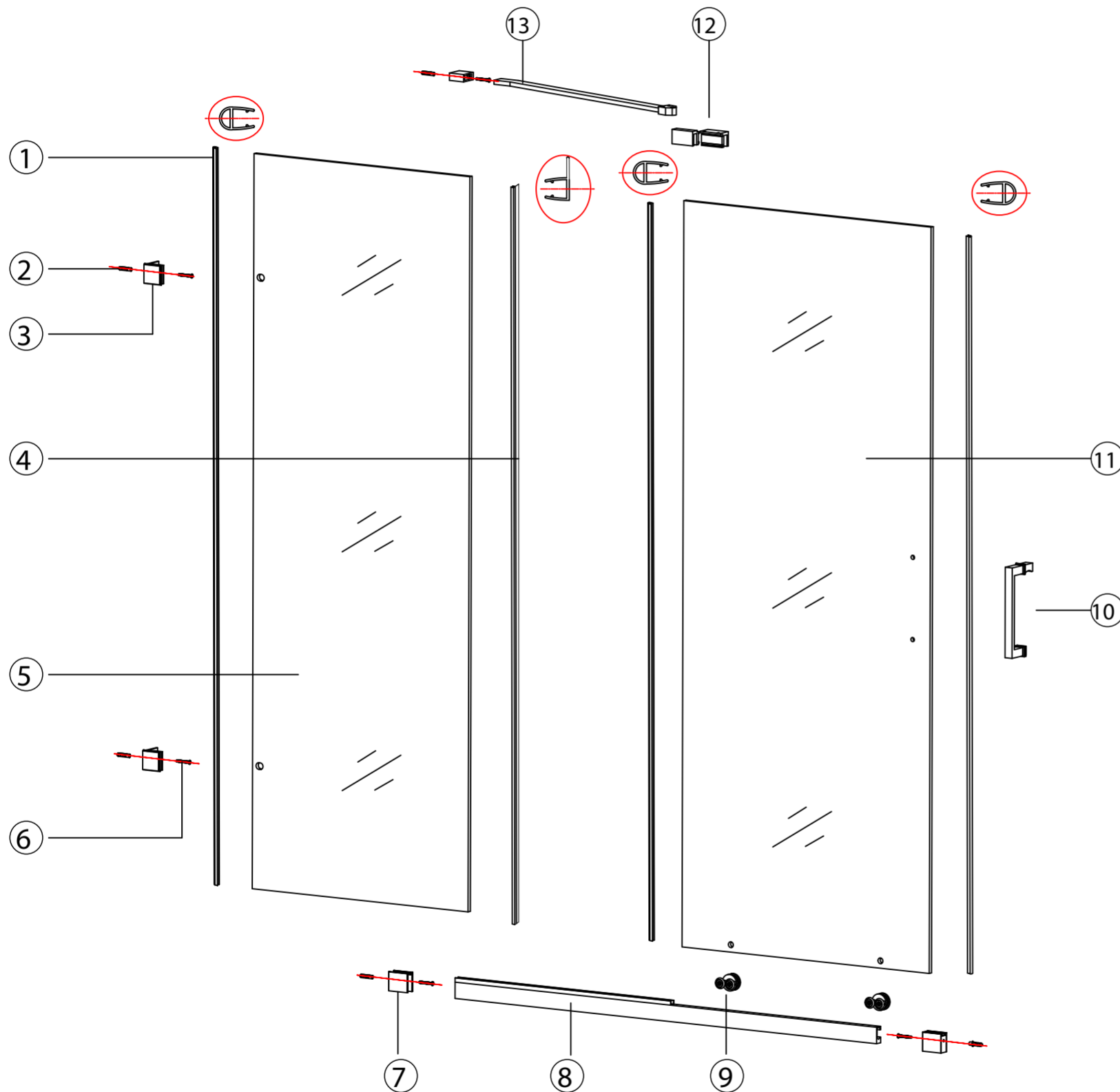

Component list

NO.	Description	Drawing	Qty
①	Rubber seal		3
②	Wall anchor(8)		5
③	Glass support		2
④	Door side seal strip		1
⑤	Fixed glass panel		1
⑥	ST5*40		5
⑦	Wall mounted bracket		2
⑧	Structural rail		1
⑨	Single Rollers		2
⑩	Handle		4
⑪	Moving glass panel		1
⑫	Top bracket		1
⑬	Structural arm		1

NOTE: Unpack your unit carefully and inspect it. Identify all parts using the detailed diagram and packing list in this manual as a reference. Before discarding the carton, check for small hardware bags that may have fallen to the bottom of the box. If any parts are damaged or missing, please contact ANZZI at 1-844-44-ANZZI or support@ANZZI.com.



Guard Rail

1. Lay the structural guard rail (8) along the ground. Insert the two wall mounting brackets (7) at both ends of the structural guard rail. Mark on the wall where to drill the hole to allow the wall mounting bracket anchors to be installed.
2. Drill the holes with an 8mm drill bit and insert the white plastic anchors. Before screwing the mounting brackets in place, insert the rollers (9). Once the rollers are inserted into the guard rail fix the wall mounting brackets to the wall.

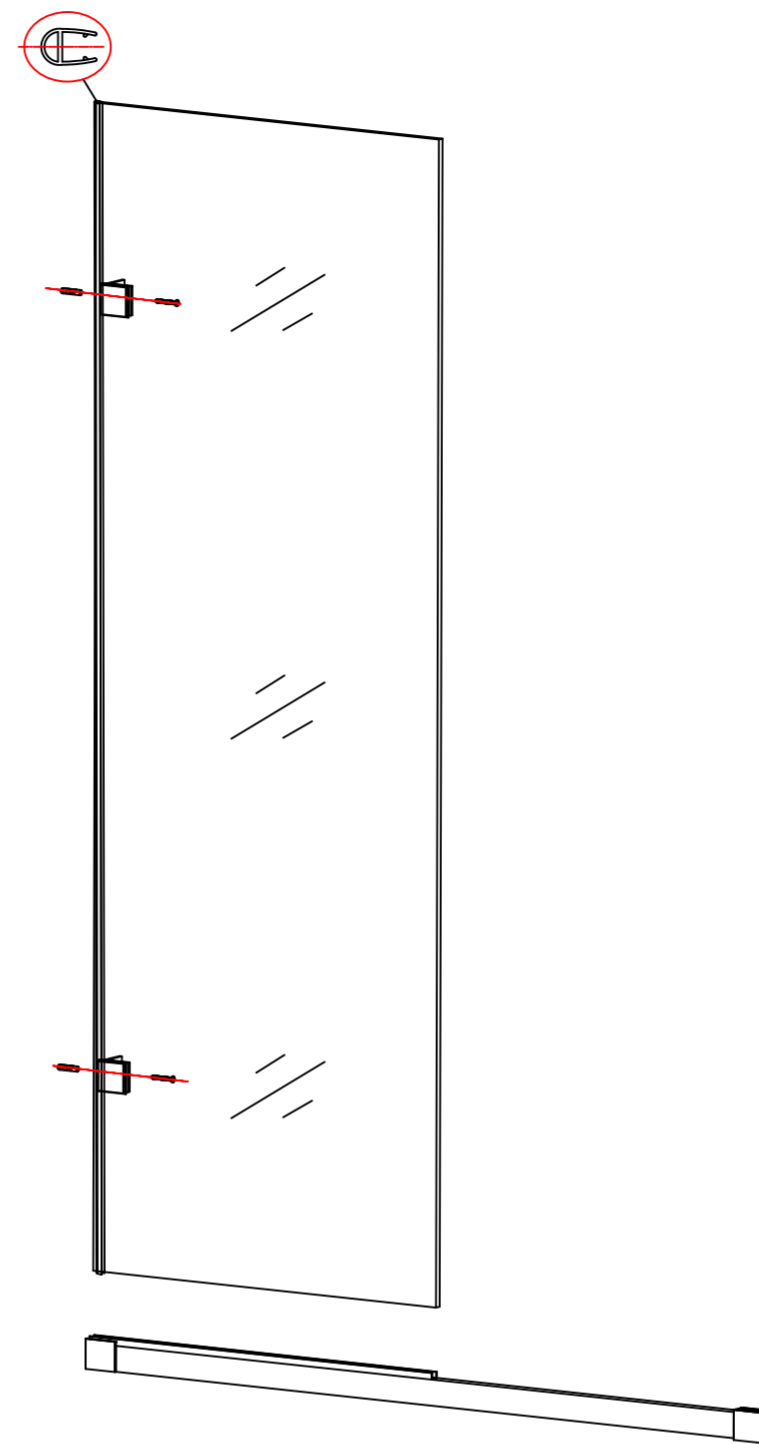

Fixed Panel

3. Install the rubber seal (1) on to the side of the fixed glass panel (5). Then, install the glass supporting brackets (3) to the fixed glass panel.
4. Insert the glass panel to the guard rail. On the shower wall mark where to drill to anchor the glass supporting brackets.
5. Move the glass panel away to make room to drill the 8mm holes for the supporting brackets and insert a white plastic anchor. Then screw the supporting bracket into the wall using the provided screws (6).

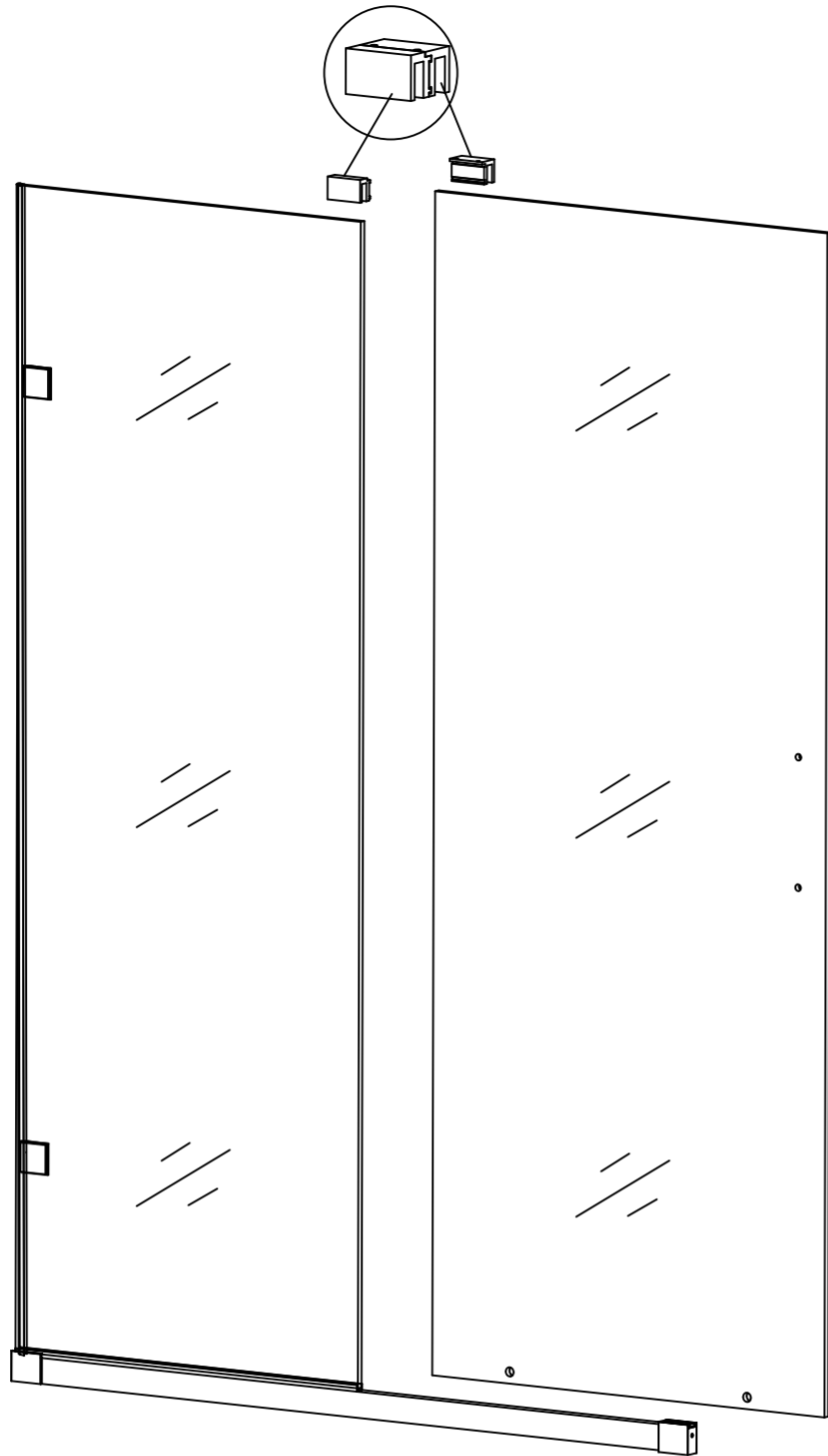

Top Bracket

6. On the top side of the fixed panel install the top bracket (12).

7. Insert the sliding glass panel (11) into place and install the top bracket on this panel as well. Make sure to line up both top bracket pieces.

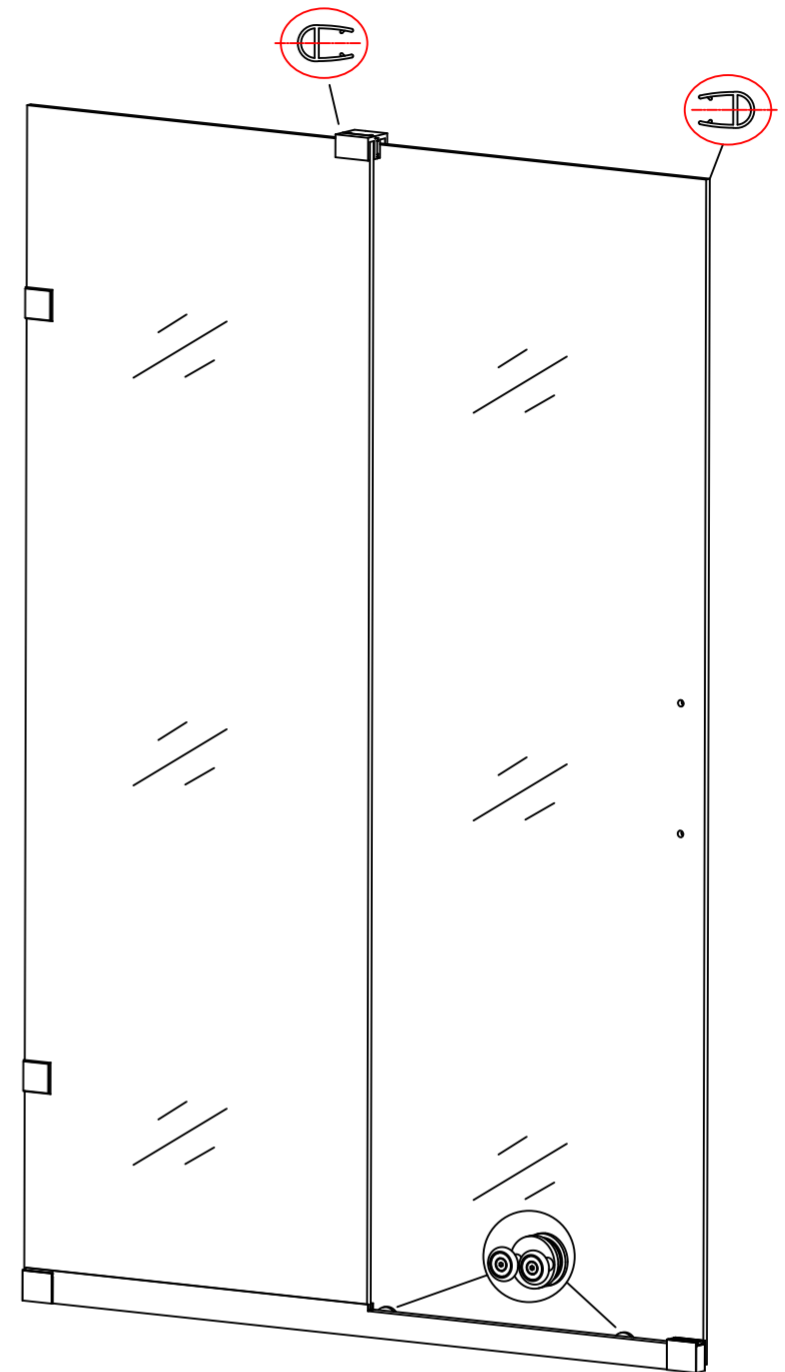

Sliding Door

8. Install the rollers to the sliding glass panel. Then install the remaining two rubber seal strippers on both ends of the sliding glass panel.

9. Close the sliding glass door and inspect to make sure there is no gap between the sliding glass panel and the wall. Make any adjustments as need to the top mounting bracket to achieve the correct extension of the door.

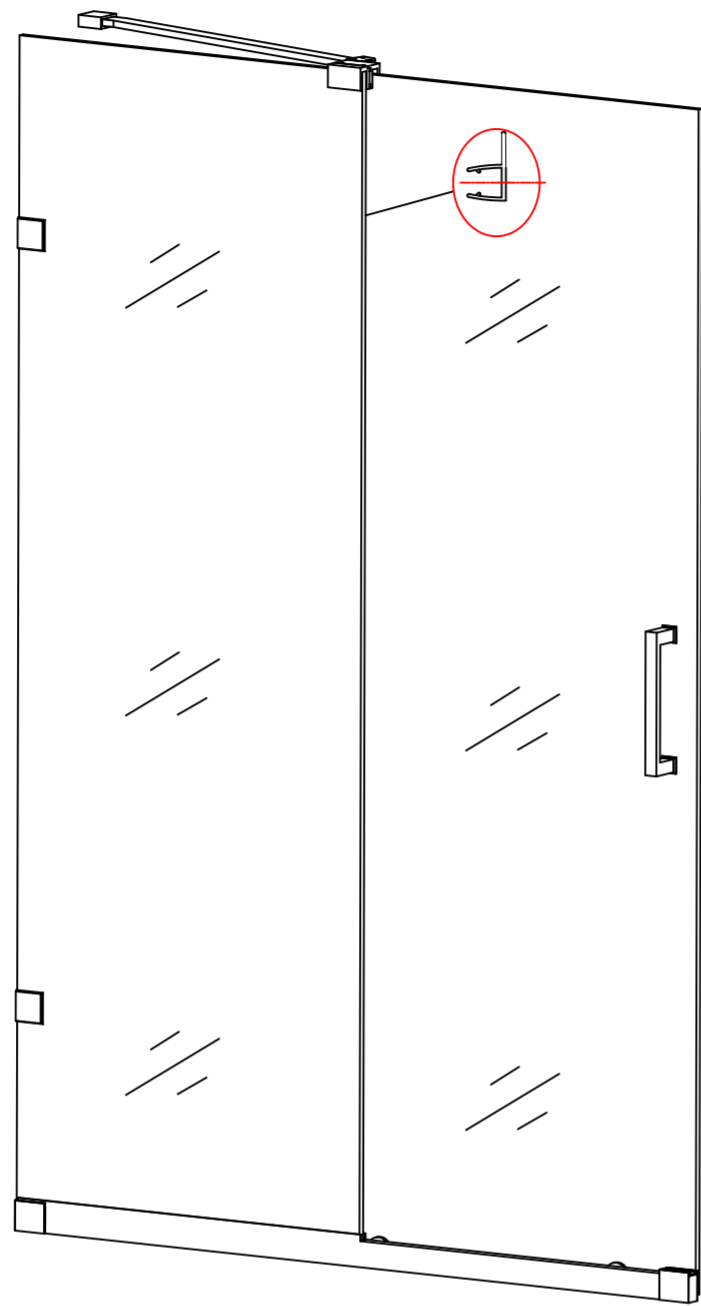

Finishing

10. Position the structural arm (13) and install to the top mounting brackets and the wall.
11. Fix the handle (10) to the sliding glass panel.
12. Install the door side seal (4) to the fixed glass panel's edge.