

# 58" CAST IRON ROLL TOP TUB

Cat. No.  
CTRH58



L: 58"  
W: 30 1/2"  
H: 22 3/4" (from floor to top of tub)

Depth: 11" to overflow

## The following is recommended for CTRH58 tubs with faucet holes:

- Tub wall-mounted faucets or hand-held showers: part# **4022, 4025, 4035**
- Tub wall-mounted faucets for use with risers: part# **4001, 4013, 4023, 4030, 4031**
- Double offset bath supplies: part **#5576**
- Leg tub drain: part **#5599**
- Complete shower unit: part# **4124, 4143**

Gallon Capacity:	61
Shipping Weight:	426 lbs.
Empty Weight:	246 lbs.
Filled Weight:	755 lbs.

## Features:

- ▶ Inside finish is white enamel
- ▶ Ball and claw feet available in 6 finishes
- ▶ Tub exterior is white (epoxy)
- ▶ 3 3/8" centers in tub wall
- ▶ Feet are attached and leveled before shipment
- ▶ Tub is thoroughly inspected before shipment

## Foot Finishes:

<b>BP</b> Polished Brass	<b>SN</b> Brushed Nickel
<b>CP</b> Polished Chrome	<b>WH</b> White
<b>PN</b> Polished Nickel	<b>ORB</b> Oil-rubbed Bronze

## Extra Paint Charge (inside of tub is always white enamel):

**Bisque Paint** - \$160

**Black Paint** - \$160

Bathtubs painted in bisque or black are considered "special order" and are not returnable.

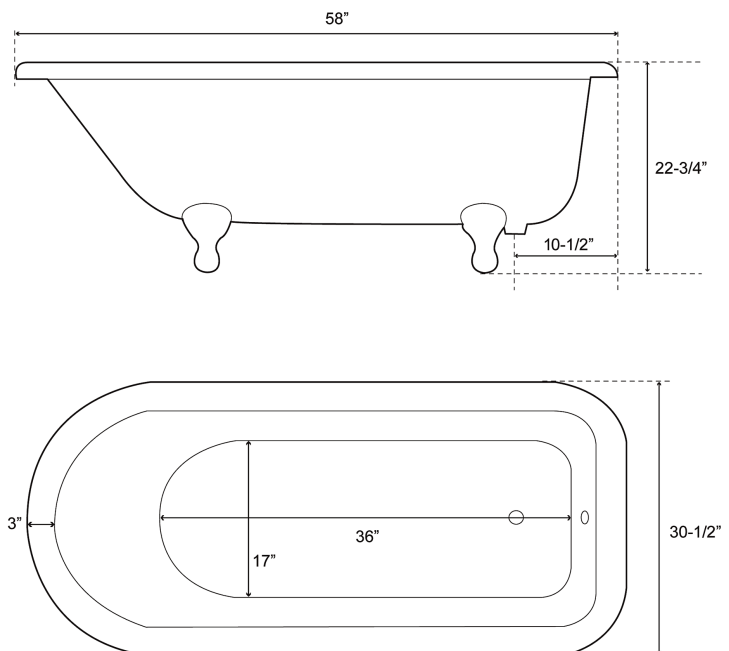

Dimensions of fixture are nominal and may vary within the range of tolerances established by ANSI Standard A112.19.2. Dimensions and specifications subject to change without notice.